

# 8800

*YOUR TYRE  
CHANGER  
OF CHOICE*

**SMARTSPEED**<sup>™</sup>



# HIGH PRODUCTIVITY EASE OF USE LESS TECHNICIAN'S FATIGUE

monty® 8800 combines the high productivity features of a tabletop tyre changer and the high performances of those leverless.



## POWERMONT™

The innovative system to mount & demount tyres



smartSpeed™ continuously controls the mount/demount conditions in order to provide the optimum torque/speed combination to the motor

- **SAFE:** always the most appropriate torque to avoid interruption of the process and damages to tyre and rim
- **FAST:** automatically selects the maximum speed possible up to 20 rpm
- **EASY TO USE:** smartSpeed™ automatically sets the speed to the torque required



## OPTIMUM BEAD BREAKER SYSTEM

The most performing solution for any tyre's types



### Dynamic bead breaker

- The bead breaking of choice for RFT, UHP and low aspect ratio tyres – Precise and damage free
- Disk position synchronized by servo drive – Fast & precise
- Disk pneumatic tilt - Optimum performance with stuck beads
- Ergonomic & effortless



### On floor bead breaker \*

- The fastest solution for tyres with soft sidewall and high aspect ratio
- Ease of use
- Shovel actuated by a switch on the handle
- On floor bead breaker assures high productivity with standard tyres

(\*) monty® 8800s and higher models

## QUICKLOK™

The fast and effortless automatic wheel clamping

- Electromechanical lock and unlock of the wheel via switch on the control panel for easy clamping
- Center post design - more flexibility in wheel clamping
  - No restriction on rim size
  - No wheel damage
  - No need to "push" the rim into the jaws
  - No jaw protection
- Constant locking force
- Fast as a tabletop tyre changer with steel wheels
- Easy and damage free with UHP and run-flat tyres
- Effortless

# POWERMONT™

The innovative system  
to mount & demount tyres

**monty®**  
TYRE CHANGERS

## FAST

- Automatic synchronization of all tools positions
- Fast disengage and repositioning of the mount/demount tool
- Standalone tool for lower bead mounting

## EASY TO USE

- Control of the mount/demount tool's trajectory
- Intuitive and simple control of the operations

## SAFE

- Thin mount / demount finger protects the bead from stress during mounting
- Servo assisted movement of the mount / demount tool, the finger follows the rim profile and prevents damages of TPMS and valve
- Integral and soft tool protection avoids rim damage

## RELIABLE

- Long lasting mount / demount tool made of steel with integrated plastic protection

### Demounting sequence



### Mounting sequence

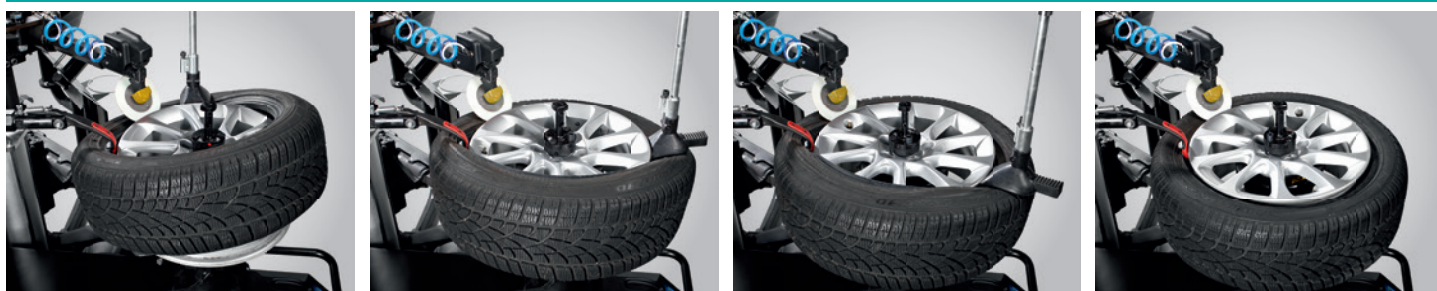

Features	monty® 8800b	monty® 8800s	monty® 8800g	monty® 8800p
Clamping range	12" – 30"	12" – 30"	12" – 30"	12" – 30"
Max tyre width	380 mm	380 mm	380 mm	380 mm
Max wheel dimension	47"	47"	47"	47"
smartSpeed™	CW 7 – 20 rpm	CCW 7 – 20 rpm	CCW 7 – 20 rpm	CCW 7 – 20 rpm
quickLOK™	control panel	control panel	w/wireless command	w/wireless command
powerMONT™	standard	standard	standard	standard
Optimum bead breaker system	n.a	standard	standard	standard
Bottom bead viewer	mirror	mirror	mirror	camera
Bead seater	n.a.	n.a.	standard	standard
Wheel lift	option	option	option	standard

**EMEA-JA**  
Snap-on Equipment s.r.l. - Via Prov. Carpi, 33 - 42015 Correggio (RE)  
Phone: +39 0522 733-411 - Fax: +39 0522 733-479 - www.hofmann-equipment.com

**Austria**  
Snap-on Equipment Austria GmbH - Hauptstrasse 24/Top 14 - A-2880 St. Corona/Wechsel (RE)  
Phone: +43 1 865 97 84 - Fax: +43 1 865 97 84 29 - www.hofmann-equipment.com

**France**  
Snap-on Equipment France - ZA du Vert Galant - 15, rue de la Guivernone BP 97175  
Saint-Ouen-l'Aumône - 95056 Cergy-Pontoise CEDEX  
Phone: +33 134 48 58-78 - Fax: +33 134 48 58-70 - www.hofmann-equipment.com

**Germany**  
Snap-on Equipment GmbH - Konrad-Zuse-Straße 1 - 84579 Unterneukirchen  
Phone: +49 8634 622-0 - Fax: +49 8634 5501 - www.hofmann-equipment.com

**Italy**  
Snap-on Equipment s.r.l. - Via Prov. Carpi, 33 - 42015 Correggio (RE)  
Phone: +39 0522 733-411 - Fax: +39 0522 733-410 - www.hofmann-equipment.com

**United Kingdom**  
Snap-on Equipment Ltd. - Unit 17 Denney Road, King's Lynn - Norfolk PE30 4HG  
Phone: +44 118 929-6811 - Fax: +44 118 966-4369 - www.hofmann-equipment.com